

ATLANTIS

1518CD-LED

ATLANTIS LARGE LED PATH LIGHT

Atlantis features a minimalist design for the ultimate in urban sophistication. Constructed of solid aluminum and Dark Sky compliant, Atlantis provides a chic solution to eco-conscious homeowners.

| DETAILS | |
|-----------|---|
| FINISH: | Cedar |
| MATERIAL: | Natural Cedar |
| GLASS: | Etched Lens |
| DIMMABLE: | YES, 12V ON MLV DIMMER ONLY, 120V ON ELV DIMMER ONLY. |

| DIMENSIONS | |
|------------|------|
| WIDTH: | 6.5" |
| HEIGHT: | 22" |
| DEPTH: | 1.6 |
| WEIGHT: | 2lb |

| LIGHT SOURCE | |
|---------------------------|---|
| LIGHT SOURCE: | Integrated LED |
| LED NAME: | NX3 |
| VOLTAGE: | 12v |
| COLOR TEMP: | 2700 |
| LUMENS: | 250 |
| CRI: | 80 |
| INCANDESCENT EQUIVALENCY: | 1 x 25W |
| DIMMABLE: | YES, 12V ON MLV DIMMER ONLY, 120V ON ELV DIMMER ONLY. |

| MOUNTING | |
|------------|---------|
| LEAD WIRE: | 1 X 36" |

| SHIPPING | |
|----------------|------|
| CARTON LENGTH: | 8.5 |
| CARTON WIDTH: | 24.5 |
| CARTON HEIGHT: | 4.3 |
| CARTON WEIGHT: | 3 |

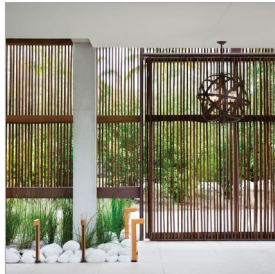

PRODUCT DETAILS:

- A wiring kit and ground spike are supplied
- Suitable for use in wet (outdoor direct rain) locations as defined by NEC and CEC. Meets United States UL Underwriters Laboratories & CSA Canadian Standards Association Product Safety Standards
- Photometrics based off engine photometrics.
- For more information on how to control your landscape lighting via the Hinkley Home Automation App, click [here](#).
- Fixture is made from natural cedar wood, featuring individually unique wood grain patterns and color tones
- LED integrated components carry a 10-year limited warranty
- Bold lines and a clean, minimalist style complement contemporary architecture
- Rich rustic finish with a warm artisanal appearance

HINKLEY

HINKLEY
33000 Pin Oak Parkway
Avon Lake, OH 44012

PHONE: (440) 653-5500
Toll Free: 1 (800) 446-5539

hinkley.com